



# SEN Louvre 033

## Specification sheet



<b>Dimension</b>	H61.5/W39.2/L210-1210mm (H2.42/W1.54/L8.27-47.64in)
<b>PCB increment</b>	100mm (3.94in)
<b>LED pitch</b>	33mm - 30LED/m (1.30in - 9.1LED/ft)
<b>Chip</b>	<b>hcc-line</b> Cree
<b>Beam angle</b>	10°/20°/30°
<b>Colours</b>	<b>hcc-line</b> White: 2700K/3000K/3500K/4000K/5000K Single colours: Red/Green/Blue
<b>Bin/Step</b>	<b>hcc-line</b> 3-step MacAdam Ellipse
<b>CRI</b>	80 (2700K-4000K)/75 (5000K)
<b>Lifetime</b>	50,000 hours @ 25°C (50,000 hours @ 77°F)
<b>Operating temp</b>	350mA: T <sub>a</sub> = -25 to 75°C (T <sub>c</sub> max = 87.6°C) T <sub>a</sub> = -13 to 167°F (T <sub>c</sub> max = 189.7°F) 700mA: T <sub>a</sub> = -25 to 45°C (T <sub>c</sub> max = 67.5°C) T <sub>a</sub> = -13 to 113°F (T <sub>c</sub> max = 153.3°F)
<b>IP rating</b>	IP54/67
<b>Finish</b>	Silver anodised
<b>Cover/lens</b>	Clear
<b>Mounting</b>	Surface mounting via brackets
<b>Power feed</b>	Sheathed hardwire tail
<b>Control</b>	0-10V/1-10V/DMX/DALI via. External power supply options



### LED Grading Key

<b>hcc-line*</b>	Constant Current Lensed High Power LED 2-step CCT range (4-step for 5000K, 6500K)	*KKDC tuned CCT range
------------------	---	-----------------------

### PERFORMANCE DATA @ 3000K

Power consumption	Supply voltage	Supply current
TYP. 32.025W/m (9.76W/ft) @ 350mA TYP. 69.3W/m (21.12W/ft) @ 700mA	TYP. 91.5V/m (27.9V/m) @ 350mA TYP. 99.0V/m (30.2V/m) @ 700mA	0.35/0.7A/m (0.107/0.213A/ft)

	Clear Cover 10°	Clear Cover 20°	Clear Cover 30°	CRI	R9	Rf	Rg
<b>hcc-line</b>	1958lm/m (597lm/ft), 61.1lm/W @ 3000K, 350mA	1849lm/m (564lm/ft), 57.7lm/W @ 3000K, 350mA	1464lm/m (446lm/ft), 45.7lm/W @ 3000K, 350mA	-	-	-	-
	3070lm/m (936lm/ft), 44.3lm/W @ 3000K, 700mA	2901lm/m (884lm/ft), 41.9lm/W @ 3000K, 700mA	2297lm/m (700lm/ft), 33.1lm/W @ 3000K, 700mA	-	-	-	-

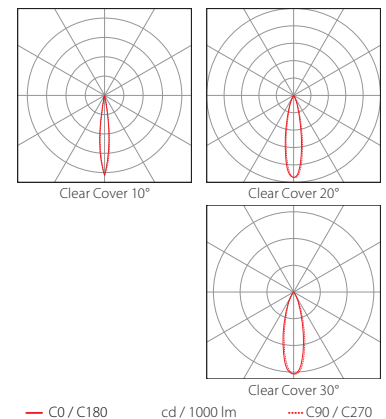
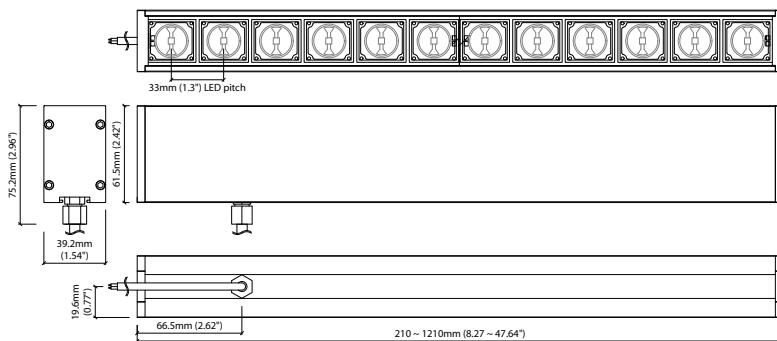

Data derived from independent UKAS/IESNA LM-79-08 accredited testing of production samples.

High Power

# SEN Louvre 033 (350mA) Length Availability List



Length Code		Fixture Length <sup>1</sup>		LED Strip		End Cap Dimension <sup>2</sup>		Wattage (W)	Output (lm)	
Metric	Imperial(US)	Metric	Imperial(US)	Metric	Imperial(US)	Metric	Imperial(US)		3000K (Test Data)	Range Data
m0210	i0008	210mm	8.27in	200mm	7.87in	10mm	0.39in	6.40	391	234-407
m0310	i0012	310mm	12.20in	300mm	11.81in	10mm	0.39in	9.60	587	351-610
m0410	i0016	410mm	16.14in	400mm	15.75in	10mm	0.39in	12.80	782	468-813
m0510	i0020	510mm	20.08in	500mm	19.69in	10mm	0.39in	16.00	978	585-1017
m0610	i0024	610mm	24.02in	600mm	23.62in	10mm	0.39in	19.20	1173	702-1220
m0710	i0028	710mm	27.95in	700mm	27.56in	10mm	0.39in	22.40	1369	819-1423
m0810	i0032	810mm	31.89in	800mm	31.50in	10mm	0.39in	25.60	1564	936-1627
m0910	i0036	910mm	35.83in	900mm	35.43in	10mm	0.39in	28.80	1760	1053-1830
m1010	i0040	1010mm	39.76in	1000mm	39.37in	10mm	0.39in	32.00	1955	1170-2033
m1110	i0044	1110mm	43.70in	1100mm	43.31in	10mm	0.39in	35.20	2151	1287-2237
m1210	i0048	1210mm	47.64in	1200mm	47.24in	10mm	0.39in	38.40	2346	1404-2440

<sup>1</sup> Length of fixture including aluminium extrusion and end clamps

<sup>2</sup> Overall dimension including both end caps and internal wiring space

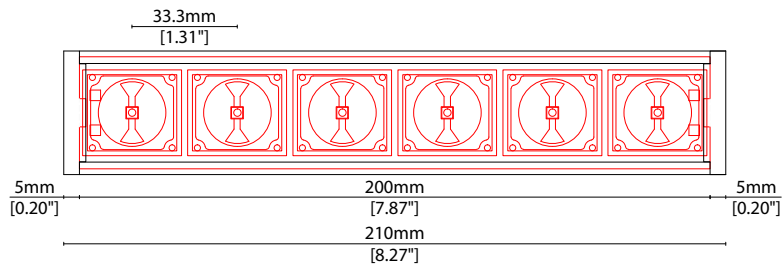

Length Code		Fixture Length <sup>1</sup>		LED Strip		End Cap Dimension <sup>2</sup>		Wattage (W)	Output (lm)	
Metric	Imperial(US)	Metric	Imperial(US)	Metric	Imperial(US)	Metric	Imperial(US)		3000K (Test Data)	Range Data
m0210	i0008	210mm	8.27in	200mm	7.87in	10mm	0.39in	13.86	614	367-639
m0310	i0012	310mm	12.20in	300mm	11.81in	10mm	0.39in	20.79	921	551-958
m0410	i0016	410mm	16.14in	400mm	15.75in	10mm	0.39in	27.72	1228	734-1277
m0510	i0020	510mm	20.08in	500mm	19.69in	10mm	0.39in	34.65	1535	918-1596
m0610	i0024	610mm	24.02in	600mm	23.62in	10mm	0.39in	41.58	1842	1101-1916
m0710	i0028	710mm	27.95in	700mm	27.56in	10mm	0.39in	48.51	2149	1285-2235
m0810	i0032	810mm	31.89in	800mm	31.50in	10mm	0.39in	55.44	2456	1468-2554
m0910	i0036	910mm	35.83in	900mm	35.43in	10mm	0.39in	62.37	2763	1652-2874
m1010	i0040	1010mm	39.76in	1000mm	39.37in	10mm	0.39in	69.30	3070	1835-3193
m1110	i0044	1110mm	43.70in	1100mm	43.31in	10mm	0.39in	76.23	3377	2019-3512
m1210	i0048	1210mm	47.64in	1200mm	47.24in	10mm	0.39in	83.16	3684	2202-3831

<sup>1</sup> Length of fixture including aluminium extrusion and end clamps

<sup>2</sup> Overall dimension including both end caps and internal wiring space

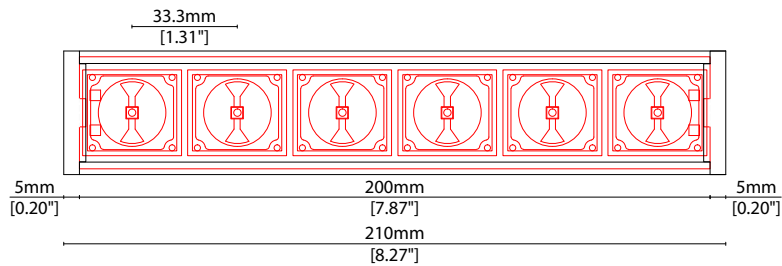

High Power

# SEN Louvre 033 Accessories

# KKDÖ

## MOUNTING OPTIONS

Note: Accessories are to be ordered separately with corresponding code shown below.



**KKBK-02**

Fixed bracket (allow 2 per metre/40in)  
Steel finish  
Pre-assembled for double tail

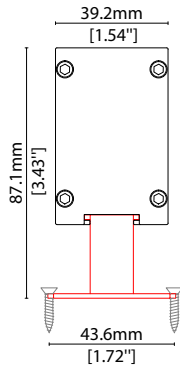

**KKBK-09**

Mounting plate  
(allow 2 per metre/40in – factory fitted)  
Silver anodised aluminium finish  
Pre-assembled for double tail

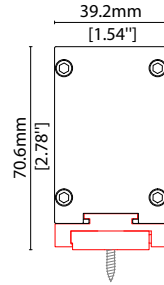

**KKBK-23**

Low adjustable bracket  
(allow 2 per metre/40in)  
Silver anodised aluminium finish  
Pre-assembled for double tail

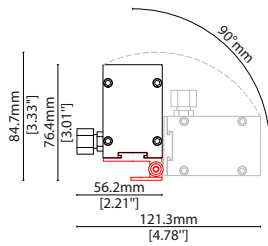

**KKBK-16**

Small adjustable bracket  
(allow 2 per metre/40in)  
Silver anodised aluminium finish  
Pre-assembled for double tail

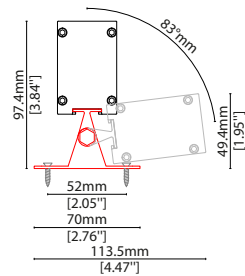

**KKBK-17**

Large adjustable bracket  
(allow 2 per metre/40in)  
Silver anodised aluminium finish  
Pre-assembled for double tail

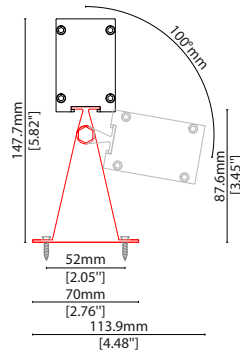

**KKSU-05**

Quick release suspension wire kit

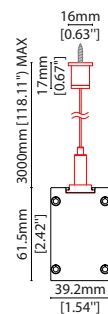



# SEN Louvre 033 Accessories



## EXTERIOR JUNCTION BOXES

---



KKJB-07

IP67 Slim J-Box  
(including type A,B,C,D bushings)



KKJB-07R

Potting resin for IP67 Slim J-Box



# SEN Louvre Driver/PSU Options



## AVAILABLE PSU OPTIONS

Control Mode	PSU (Order Code)	Input Voltage AC	Output Voltage DC	Rated Output Current	Rated Power	Dim %	IP Rating
Switched	HLG-60H-C350A	90-305V	100V-200V	0.35A	70W	-	IP65
	HLG-60H-C700A	90-305V	50V-100V	0.7A	70W	-	IP65
	HLG-80H-C350A	90-305V	128V-257V	0.35A	90W	-	IP65
	HLG-80H-C700A	90-305V	64V-129V	0.7A	90W	-	IP65
	HLG-120H-C350A	90-305V	215-430V	0.35A	150W	-	IP65
	HLG-120H-C700A	90-305V	107V-215V	0.7A	150W	-	IP65
	HLG-185H-C700A	90-305V	143V-286V	0.7A	199W	-	IP65
0-10V (1-10V)	HLG-60H-C350B	90-305V	100V-200V	0.35A	70W	-	IP67
	HLG-60H-C700B	90-305V	50V-100V	0.7A	70W	-	IP67
	HLG-80H-C350B	90-305V	128V-257V	0.35A	90W	-	IP67
	HLG-80H-C700B	90-305V	64V-129V	0.7A	90W	-	IP67
	HLG-120H-C350B	90-305V	215-430V	0.35A	150W	-	IP67
	HLG-120H-C700B	90-305V	107V-215V	0.7A	150W	-	IP67
	HLG-185H-C700B	90-305V	143V-286V	0.7A	199W	-	IP67
DALI	ELG-100-C350DA	180-295V	143-286V	0.35A	100W		IP67
	ELG-100-C700DA	180-295V	71-143V	0.7A	100W		IP67
	ELG-150-C700DA	180-295V	150-300V	0.7A	150W		IP67